

PLAN SHOWING THE PROPOSED LAYOUT OF HOUSE SITES IN S.F.NO: 361/2A2, 366/2A, OF SEERAPALAYAM VILLAGE & PANCHAYAT, MADUKKARAI TALUK, COIMBA TORE DISTRICT.

MADHAVI AVENUE

DTP APPROVED NO: 2/2015

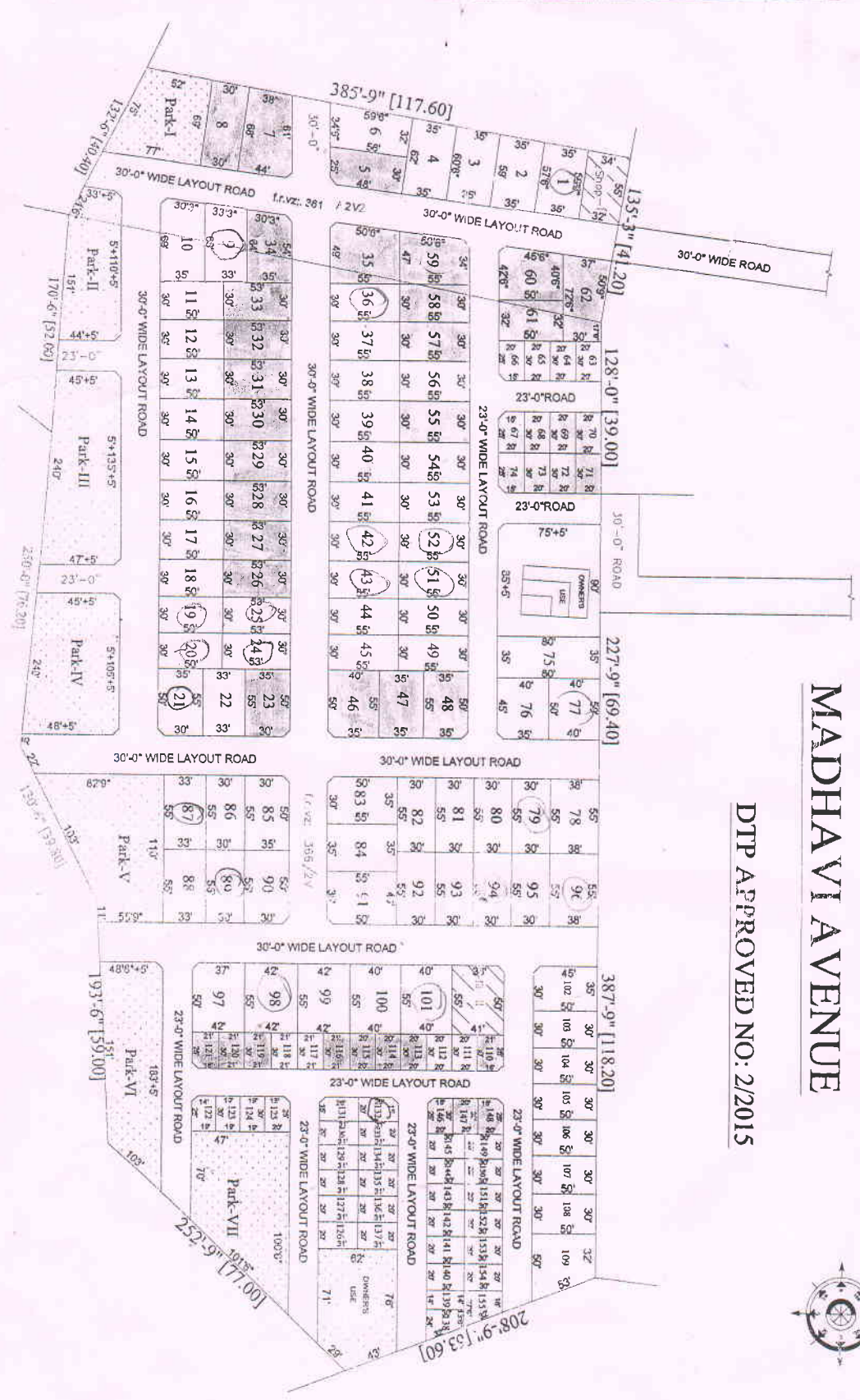

Site No.	TOTAL AREA Sqft Cents	Site No.	TOTAL AREA Sqft Cents
1	1995 4.253	89	1650 3.343
2	2039 4.297	90	1913 4.171
3	2091 4.349	91	2188 5.010
4	2144 4.402	92	92.95 1.650
5	1623 3.316	96	2090 4.348
6	1920 4.178	97	2243 5.065
7	2915 6.301	98	2310 5.132
8	2055 4.313	99	2255 5.077
9	2186 5.008	100-101	2200 5.022
10	2481 5.303	102	1738 3.431
11-20	1500 3.193	103-108	1500 3.193
21	1913 4.171	109	2112 4.370
22	1815 4.073	110	618 1.182
23	1913 4.171	111-115	600 1.164
24-33	1590 3.283	116	639 1.194
34	2148 4.406	117	600 1.164
35	2778 6.154	118-119	639 1.194
36-45	1650 3.343	120	600 1.164
46	2188 5.010	121	618 1.182
47	1925 4.183	122	558 1.122
48	2188 5.010	123-124	570 1.122
49-58	1650 3.343	125	578 1.122
59	2363 5.185	126-130	620 1.184
60	2199 5.021	131-132	698 1.172
61	1600 3.293	133-137	620 1.184
62	2358 5.180	138	581 1.145
63-65	600 1.164	139	420 0.820
66-67	588 1.152	140-145	600 1.164
68-73	600 1.164	146	588 1.152
74	588 1.152	147	600 1.164
75	2800 6.186	148	588 1.152
76	1988 4.246	149-154	600 1.164
77	2000 4.258	155	674 1.238
78	2090 4.348	Total	226403 519.327
79-82	1650 3.343	Shop-1,2	91603 210.217
83	1913 4.171	Shop-1,2	9365 21.217
84	1925 4.183	Other	4960 11.108
85	1650 3.343	Park-I, II, III, IV, V, VI, VIII	53472 122.329
87-88	1815 4.073		

SEETHA ASSOCIATES ENGINEERS & BUILDERS
 94/22, 12/11, SHIV POND
 MADHAVI AVENUE
 MADUKKARAI TALUK
 COIMBATORE DISTRICT
 KARNATAKA